

Cinderella

by Matthew Reinhart

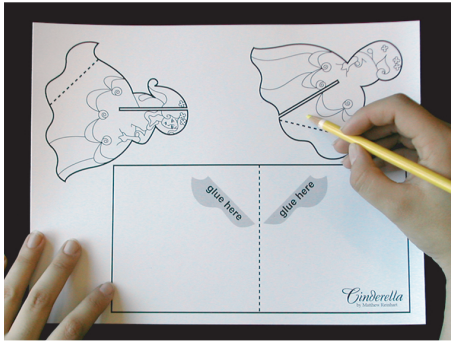

Step 1

Print out the page on heavy cardstock and then color the pieces of Cinderella. You can use crayons, pencils or markers but not paint (it will warp the paper).

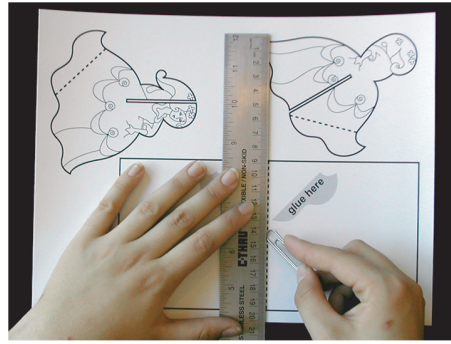

Step 2

Use the rounded end of a paper clip to "score" (press along) the dotted lines. Score both Cinderella pieces and down the center of the card itself.

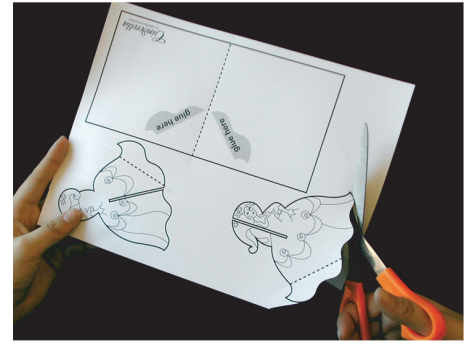

Step 3

Carefully cut out the pop-up pieces and card along the thick, black outline.

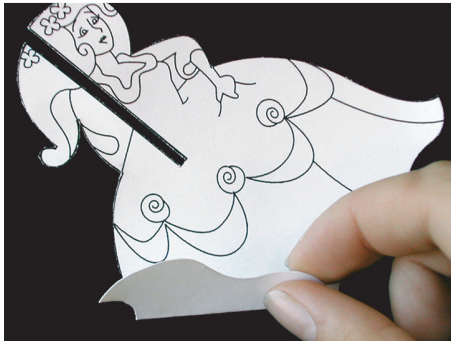

Step 4

Fold along the dotted line on the piece with Cinderella's face.



Step 5

Put a small amount of white glue on the left grey shape labeled "glue here" and place the edge of Cinderella's dress on top of the glue. Let dry!

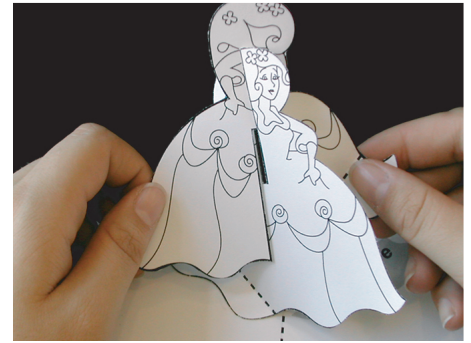

Step 6

After folding along the dotted line, slide the second Cinderella piece down into the front piece. Make sure that Cinderella's head is in front as shown.

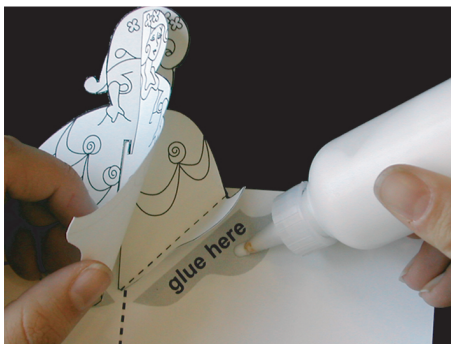

Step 7

Put glue on the right grey shape labeled "glue here" and line up the edge of the dress on the card. Let dry!



Step 8

Carefully close card, then pop-up!

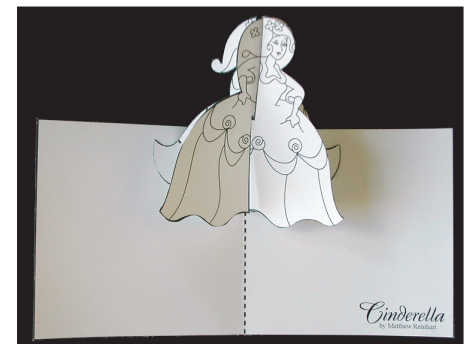

You can make this pop-up larger by enlarging the print outs on a photocopy machine. Make sure that you enlarge the pop-up pieces and card the exact same amount.

Enjoy!

